

VALVE CONFIG.	PLUG TRAVEL	PLUG POSITIONS			
		1	2	3	4
012	90°	X	X		
023	90°		X	X	
034	90°			X	X
041	90°	X			X
123	180°	X	X	X	
234	180°		X	X	X
341	180°	X		X	X
412	180°	X	X		X
1234	360°	X	X	X	X

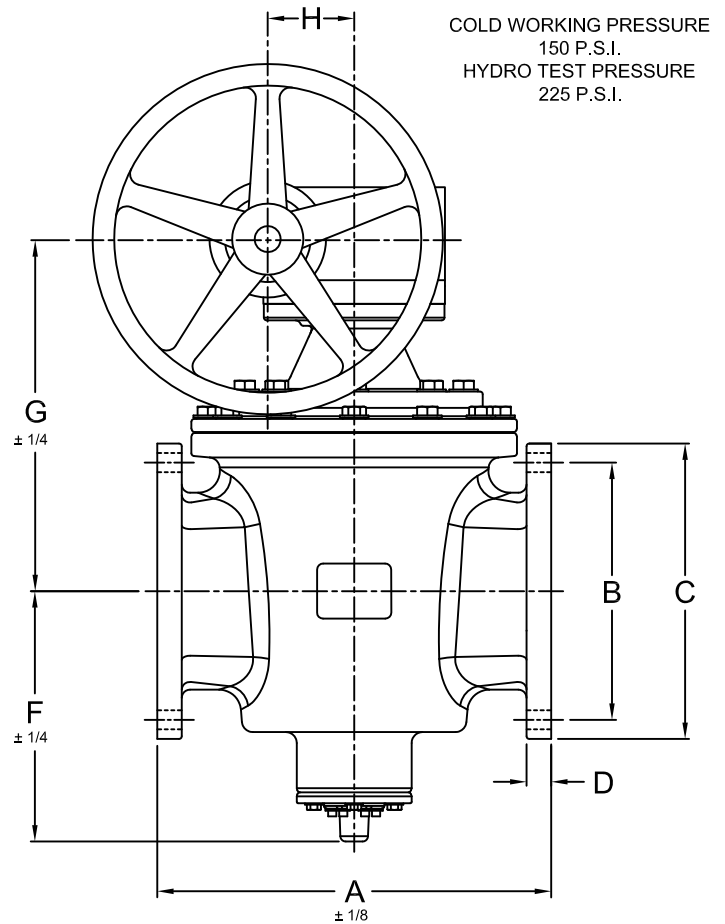
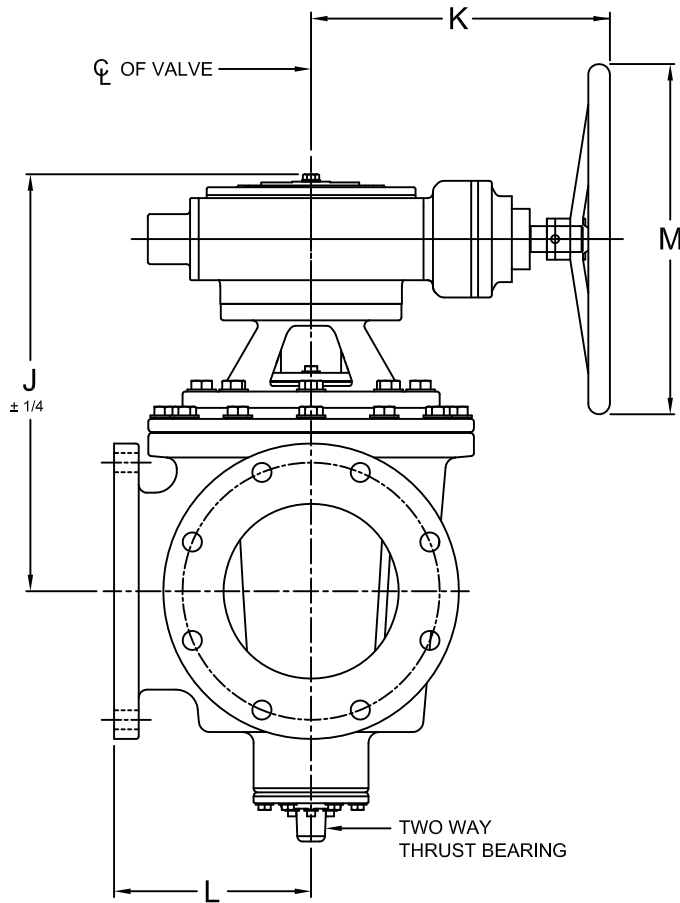

DRAWING DEPICTS 8" VALVE SIZE TO SCALE.

### FLANGE DIMENSIONS, INCHES

VALVE SIZE	MODEL NUMBER	90° GEAR MODEL	360° GEAR MODEL	A	B	C	D	F	G	H	J	K	L	M	BOLT SIZE	NO. OF BOLTS
4	5504	7A12	7B12	13.00	7.50	9.00	0.94	8.25	10.24	2.50	12.54	9.2	6.50	12.00	5/8	8
6	5506	7C18	7D18	16.00	9.50	11.00	1.00	9.50	13.90	3.9	16.60	13.3	8.00	18.00	3/4	8
8	5508	7E16	7F16	18.00	11.75	13.50	1.13	11.44	15.72	3.9	18.32	15.2	9.00	16.00	3/4	8
10	5510	7G24	7H24	22.00	14.25	16.00	1.19	12.44	17.22	4.9	19.92	17.7	11.00	24.00	7/8	12
12	5512	7J24	7K24	24.00	17.00	19.00	1.25	13.88	18.97	4.9	22.17	17.6	12.00	24.00	7/8	12

Revised 3-27-12

ANSI CLASS 125 3-WAY TAPERED PLUG VALVE WITH AUMA WORM GEAR ACTUATOR

DATE 9-16-11

**VAL-MATIC**

VALVE AND MANUFACTURING CORP.

DRWG. NO.  
VMC-5504/WGA