



APPROVED



LISTED

SIZES 2 1/2" - 12"

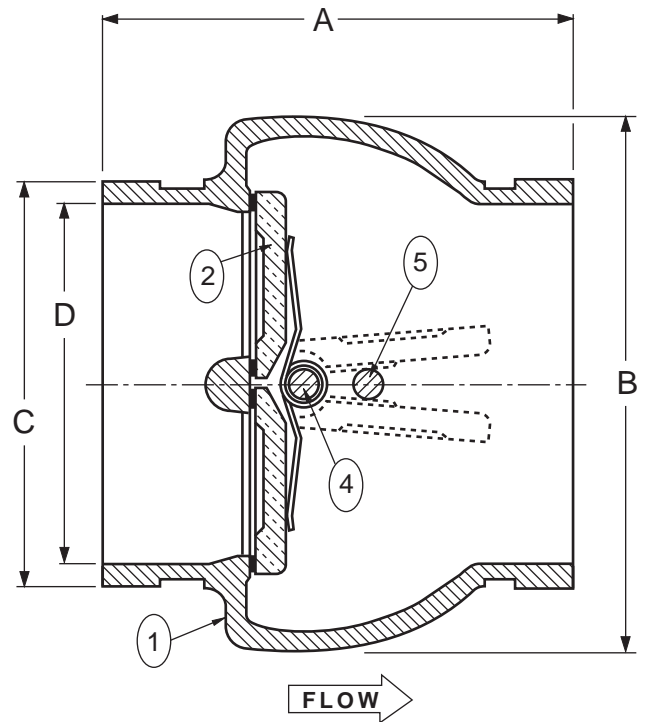
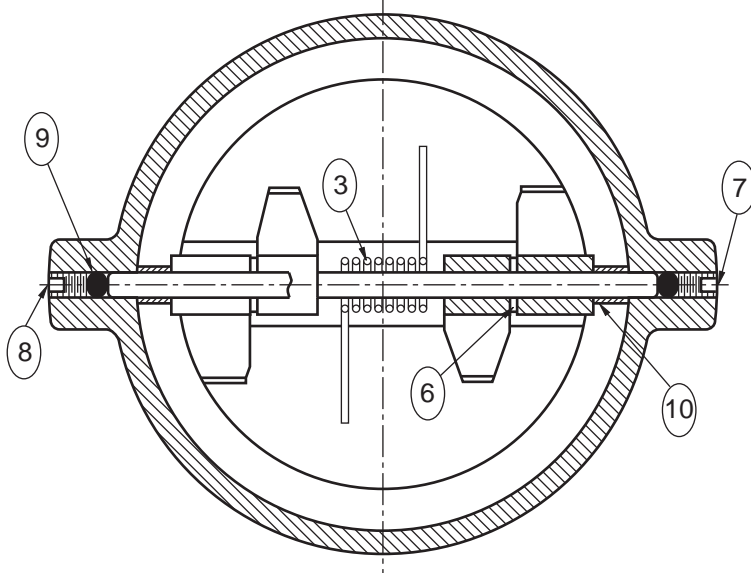

PART NO.	PART NAME
1	BODY
2	DISC
3	TORSION SPRING
4	DISC HINGE PIN
5	DISC STOP PIN

PART NO.	PART NAME
6	DISC THRUST BEARING
7	HINGE PIN RETAINER
8	STOP PIN RETAINER
9	STABILIZATION SPHERE
10	SPACER

GROOVED END DIMENSIONS					
VALVE SIZE	MODEL NO.	A	B	C	D
2	8802GN	4.66	4.12	2.38	2.00
2 1/2	8825G	4.90	4.88	2.88	2.41
3	8803G	5.31	5.38	3.50	2.94
4	8804G	5.38	6.00	4.50	3.91
5	8805G	5.72	7.06	5.56	4.89
6	8806G	6.00	8.12	6.62	5.92
8	8808G	6.72	10.03	8.62	7.91
10	8810G	7.78	12.38	10.75	10.00
12	8812G	8.18	14.38	12.75	11.94

GROOVE DIMENSIONS CONFORM TO ANSI/AWWA SPECIFICATION C606 TABLE 4 (CUT GROOVE DIMENSIONS)

PRESSURE-TEMPERATURE RATING	
TEMP. °F.	MAXIMUM NON-SHOCK PRESSURE PSI
	DUCTILE IRON CONSTRUCTION
150°	250
200°	235
250°	220
HYDROSTATIC TEST PRESSURE	500

VAL-MATIC® DUAL DISC® CHECK VALVES CAN BE USED FOR HORIZONTAL FLOW OR VERTICAL FLOW-UP APPLICATIONS ONLY. CAUTION: FOR HORIZONTAL FLOW APPLICATIONS, VALVE MUST BE INSTALLED WITH THE DISC HINGE PIN IN THE VERTICAL POSITION. SEE DRAWING NO. VM-8802W-M FOR 2"-12" STANDARD MATERIAL OF CONSTRUCTION. SIZES 10 & 12 FURNISHED WITH LIFTING EYEBOLT.

Revision 3-9-11

GROOVED END DUAL DISC® CHECK VALVE

DATE 7-21-03



VALVE AND MANUFACTURING CORP.

DRWG. NO.

VM-8802G