

TOP MOUNTED OIL DASHPOT QUICK CHANGE COUPLING DETAIL

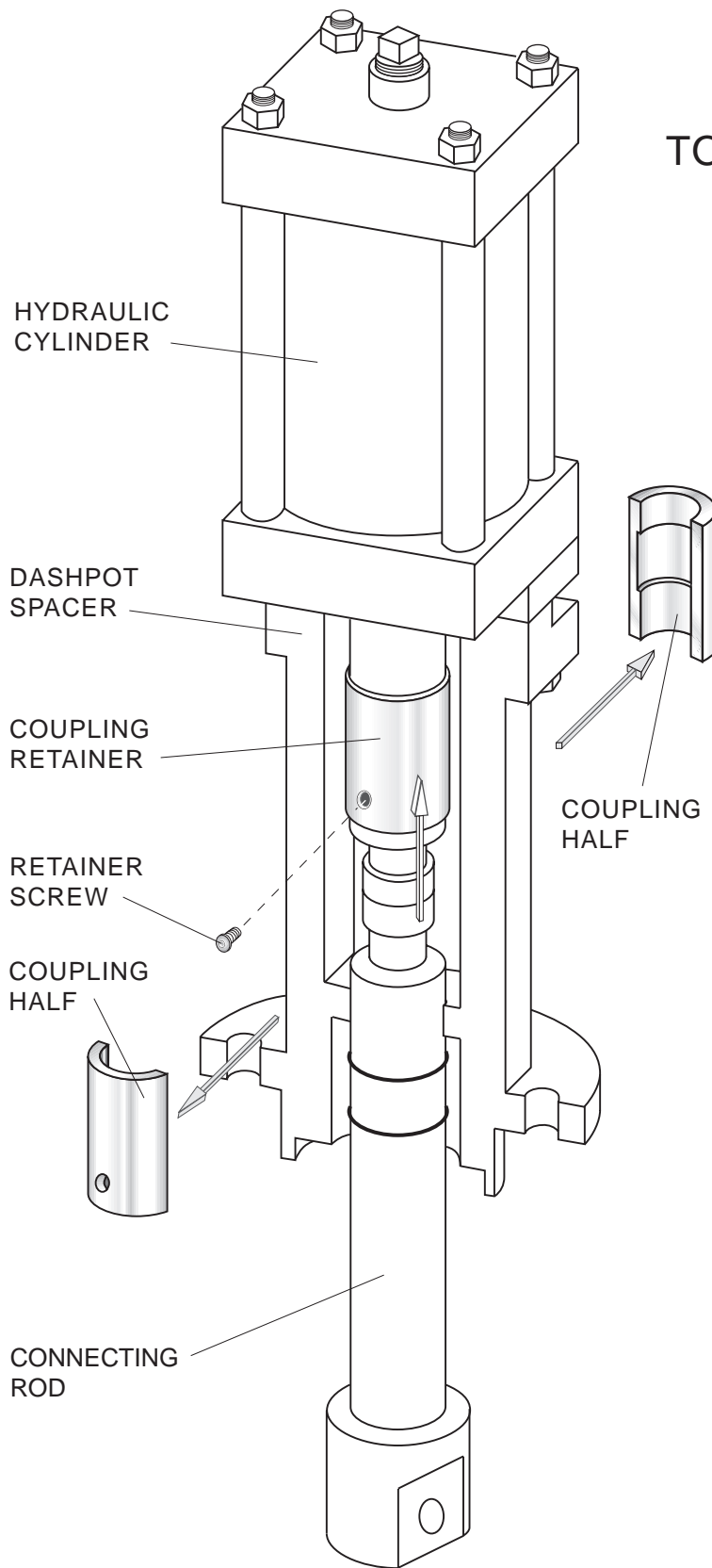

The Quick Change Coupling provides for easy removal and maintenance of the dashpot assembly while the check valve is under pressure.

The coupling also provides a self aligning connection which prolongs the life of the seals and bushings in the cylinder and dashpot assembly.

The coupling is formed in two half sections. The sections are joined together around the ends of the cylinder rod and the connecting rod and secured with an outer slip-type coupling retainer.

Stainless steel construction is provided as a standard to prevent corrosion in harsh environments.

Revised 4-7-98

TOP MOUNTED OIL DASHPOT QUICK CHANGE COUPLING DETAIL

DATE 7-30-97

VAL-MATIC[®]

VALVE AND MANUFACTURING CORP.

DRWG. NO.

SS-1400