

NOTE: THESE VALVES MATE TO WAFER STYLE BUTTERFLY VALVES WITHOUT THE USE OF SPOOL PIECES OR OTHER ADAPTERS.

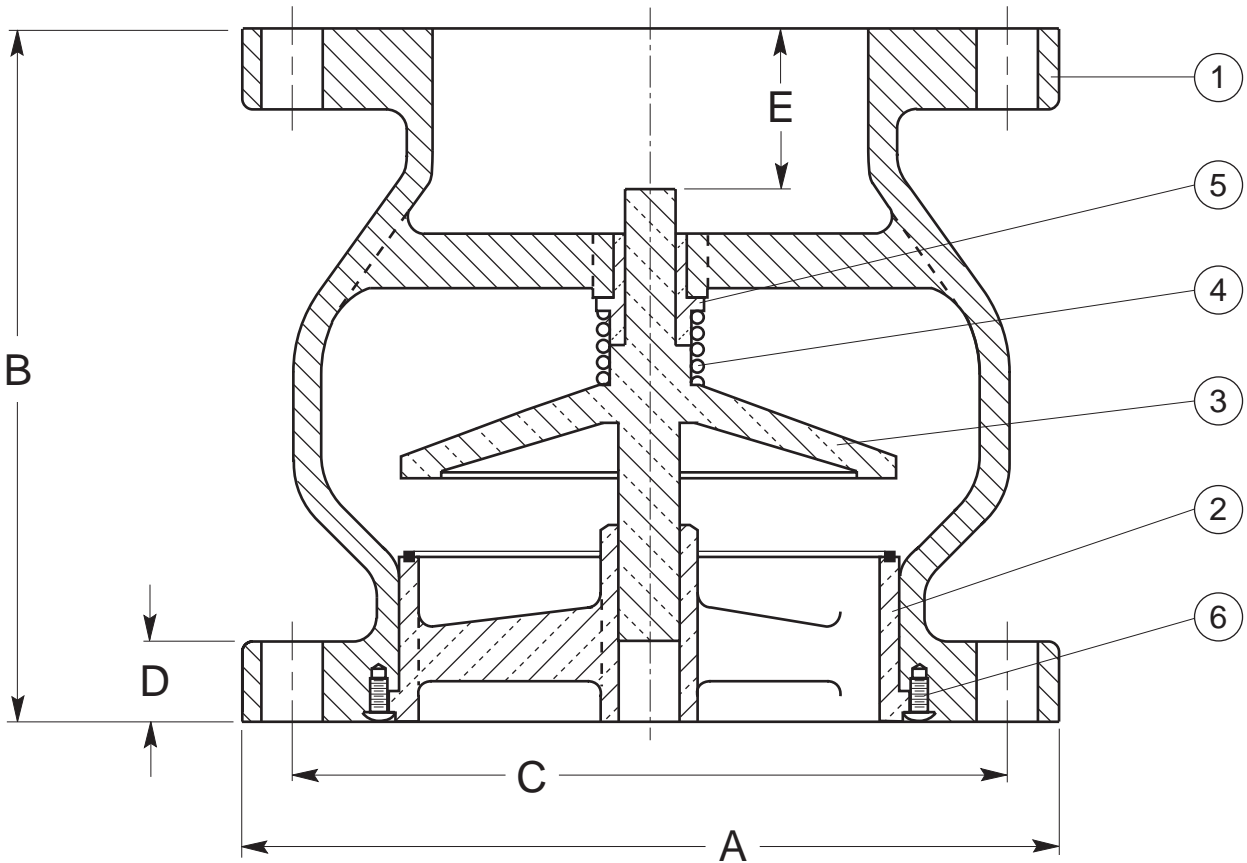

SEE DRAWING NO. VM-1802BN-M FOR STANDARD MATERIALS OF CONSTRUCTION.

ANSI CLASS 125									
VALVE SIZE	MODEL NO.*	CWP (P.S.I.)	A	B	C	D	E	BOLT SIZE	NO. OF BOLTS
2 1/2	1825BN	200	7	5 1/2	5 1/2	11/16	1	5/8	4
3	1803BN	200	7 1/2	6	6	15/16	1 3/8	5/8	4
4	1804BN	200	9	7 1/4	7 1/2	15/16	1 3/4	5/8	8
5	1805BN	200	10	8 1/2	8 1/2	15/16	2	3/4	8
6	1806BN	200	11	9 3/4	9 1/2	1	2 1/2	3/4	8
8	1808BN	200	13 1/2	12 1/2	11 3/4	1 1/8	3 1/4	3/4	8
10	1810BN	200	16	15 1/2	14 1/4	1 3/16	4 1/4	7/8	12

ANSI CLASS 250									
VALVE SIZE	MODEL NO.*	CWP (P.S.I.)	A	B	C	D	E	BOLT SIZE	NO. OF BOLTS
2 1/2	1875BN	400	7 1/2	5 1/2		1	1	3/4	8
3	1853BN	400	8 1/4	6	6 5/8	1 1/8	1 3/8	3/4	8
4	1854BN	400	10	7 1/4	7 7/8	1 1/4	1 3/4	3/4	8
5	1855BN	400	11	8 1/2	9 1/4	1 3/8	2	3/4	8
6	1856BN	400	12 1/2	9 3/4	10 5/8	1 7/16	2 1/2	3/4	12
8	1858BN	400	15	12 1/2	13	1 5/8	3 1/4	7/8	12
10	1860BN	400	17 1/2	15 1/2	15 1/4	1 7/8	4 1/4	1	16

\* MODEL NUMBERS REFLECT BRONZE TRIM.

**Installation Requirements**

Refer to drawing SS-974 entitled Silent Check Valve Flange Installation Requirements for mating flanges.

Revised 4-22-98

**GLOBE STYLE SILENT CHECK VALVE (BUNA-N)**

DATE 7-14-82



VALVE AND MANUFACTURING CORP.

DRWG. NO.

VM-1802BN