

PART NO.	PART NAME	PART NO.	PART NAME
1	BODY	5	BUSHING
2	SEAT	6	RETAINING SCREW
3	DISC	7	RETAINING NUT
4	SPRING		

SEE DRAWING NO. VM-1200-M FOR STANDARD MATERIALS OF CONSTRUCTION. *SHAFT EXTENDS PAST FLANGE FACE.

ANSI CLASS 125

VALVE SIZE	MODEL NO.	CWP (PSI)	A	B	C	D	E	BOLT SIZE	NO. OF BOLTS
3"	1203	200	7 1/2"	6"	6"	15/16"	1 3/8"	5/8"	4
4"	1204	200	9"	7 1/4"	7 1/2"	15/16"	1 3/4"	5/8"	8
6"	1206	200	11"	9 3/4"	9 1/2"	1"	2 1/2"	3/4"	8
8"	1208	200	13 1/2"	12 1/2"	11 3/4"	1 1/8"	3 1/4"	3/4"	8
10"	1210	200	16"	15 1/2"	14 1/4"	1 3/16"	4 1/4"	7/8"	12
12"	1212	200	19"	14 1/4"	17"	1 1/4"	* 5/8"	7/8"	12
14"	1214	150	21"	15 3/4"	18 3/4"	1 3/8"	* 1 5/16"	1"	12
16"	1216	150	23 1/2"	17 5/8"	21 1/4"	1 7/16"	* 2 1/8"	1"	16
18"	1218	150	25"	18 3/4"	22 3/4"	1 9/16"	* 2 1/4"	1 1/8"	16
20"	1220	150	27 1/2"	20 5/8"	25"	1 11/16"	* 2 15/16"	1 1/8"	20

ANSI CLASS 250

VALVE SIZE	MODEL NO.	CWP (PSI)	A	B	C	D	E	BOLT SIZE	NO. OF BOLTS
3"	1253	400	8 1/4"	6"	6 5/8"	1 1/8"	1 3/8"	3/4"	8
4"	1254	400	10"	7 1/4"	7 7/8"	1 1/4"	1 3/4"	3/4"	8
6"	1256	400	12 1/2"	9 3/4"	10 5/8"	1 7/16"	2 1/2"	3/4"	12
8"	1258	400	15"	12 1/2"	13"	1 5/8"	3 1/4"	7/8"	12
10"	1260	400	17 1/2"	15 1/2"	15 1/4"	1 7/8"	4 1/4"	1"	16
12"	1262	400	20 1/2"	14 1/4"	17 3/4"	2"	* 5/8"	1 1/8"	16
14"	1264	300	23"	15 3/4"	20 1/4"	2 1/8"	* 1 5/16"	1 1/8"	20
16"	1266	300	25 1/2"	17 5/8"	22 1/2"	2 1/4"	* 2 1/8"	1 1/4"	20

ANSI CLASS 125 & 250 LB. ANTI-SLAM DEVICE

DATE Revised 7-5-02
6-29-70

VAL-MATIC[®]

VALVE AND MANUFACTURING CORP.

DRWG. NO.

VM-1200

ANTI-SLAM DEVICE

1200 SERIES

STANDARD MATERIALS OF CONSTRUCTION

<u>PART NO.</u>	<u>PART NAME</u>	<u>MATERIAL</u>
1	BODY	CAST IRON ASTM A126, CLASS B
2	SEAT	BRONZE ASTM B584, ALLOY C83600
3	DISC	BRONZE ASTM B584, ALLOY C83600
4 *	SPRING	STAINLESS STEEL T302, ASTM A313
5	BUSHING	BRONZE ASTM B16, ALLOY C36000
6	RETAINING SCREW	STAINLESS STEEL T304, ASTM F879
7	RETAINING NUT	BRASS

* SPRING NOT FURNISHED ON
VALVE SIZES 14" AND LARGER.

NOTE: ALL SPECIFICATIONS AS
LAST REVISED.

Revised 5-11-98

MATERIALS OF CONSTRUCTION

DATE 5/9/67

VAL-MATIC[®]

VALVE AND MANUFACTURING CORP.

DRWG. NO.

VM-1200-M

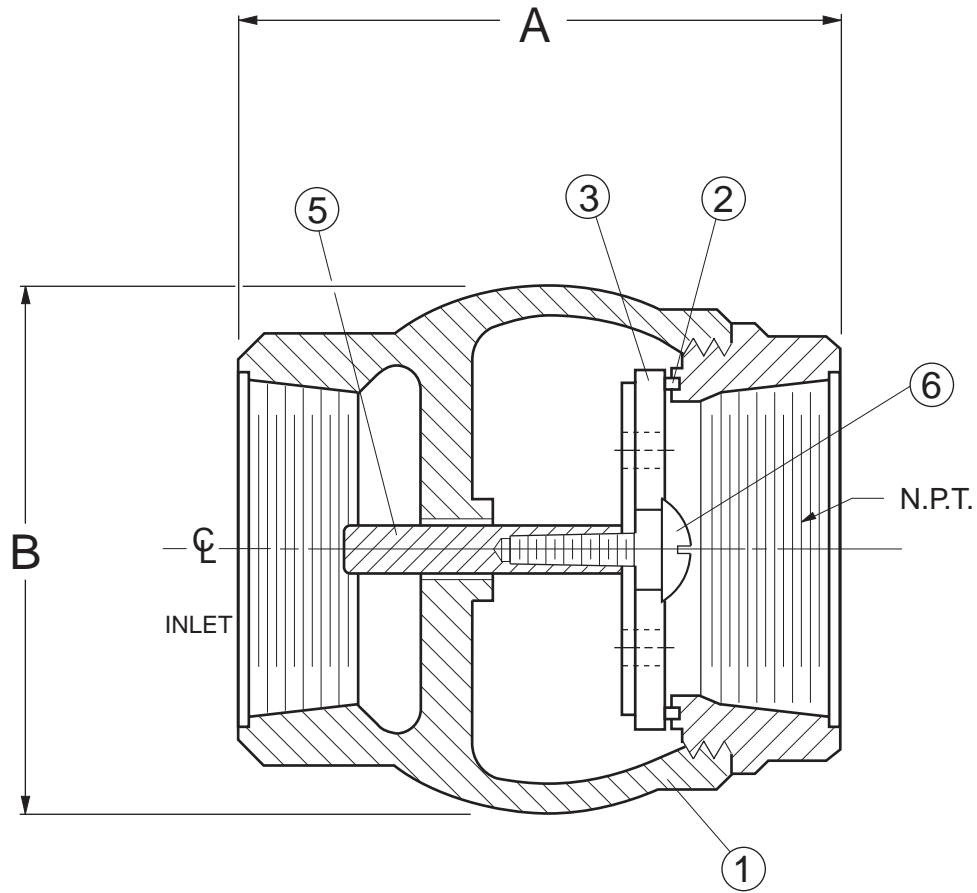

- | | |
|--------|--------------|
| 1 BODY | 5 STEM |
| 2 SEAT | 6 SEAT SCREW |
| 3 DISC | |

SEE DRAWING NO. VM-1201T-M FOR STANDARD MATERIALS OF CONSTRUCTION.

VALVE SIZE	MODEL NO.	A	B
1" N.P.T	1201T	2 5/8"	2"
2" N.P.T	1202T	3 3/4"	3 3/8"

COLD WORKING PRESSURE 250 P.S.I.

THREADED STYLE ANTI-SLAM DEVICE

DATE 5-11-98

VAL-MATIC[®]

VALVE AND MANUFACTURING CORP.

DRWG. NO.

VM-1201T

THREADED STYLE ANTI-SLAM DEVICE

SERIES NO. 1201T

STANDARD MATERIALS OF CONSTRUCTION

<u>PART NO.</u>	<u>PART NAME</u>	<u>MATERIAL</u>
1	BODY	BRONZE ASTM B-584, ALLOY C84400
2	SEAT	TEFLON (TRADEMARK OF DUPONT)
3	DISC	STAINLESS STEEL T304, ASTM A240
5	STEM	STAINLESS STEEL T303, ASTM A582
6	SEAT SCREW	STAINLESS STEEL T430, ASTM A276

NOTE: ALL SPECIFICATIONS AS
LAST REVISED.

MATERIALS OF CONSTRUCTION

DATE 5/14/98

VAL-MATIC[®]

VALVE AND MANUFACTURING CORP.

DRWG. NO.

VM-1201T-M

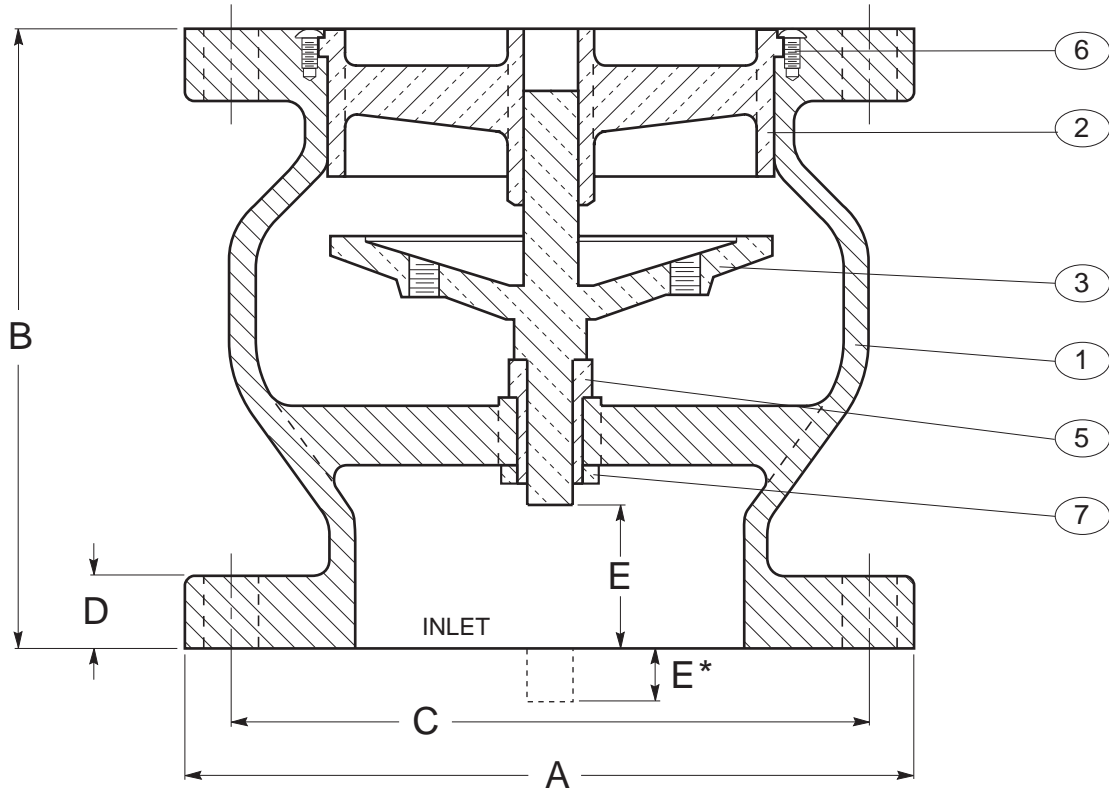

PART NO.	PART NAME	PART NO.	PART NAME
1	BODY	5	BUSHING
2	SEAT	6	RETAINING SCREW
3	DISC	7	RETAINING NUT

SEE DRAWING NO. VM-1200S-M FOR STANDARD MATERIALS OF CONSTRUCTION. *SHAFT EXTENDS PAST FLANGE FACE.

ANSI CLASS 125									
VALVE SIZE	MODEL NO.	CWP (PSI)	A	B	C	D	E	BOLT SIZE	NO. OF BOLTS
3"	1203S	200	7 1/2"	6"	6"	15/16"	1 3/8"	5/8"	4
4"	1204S	200	9"	7 1/4"	7 1/2"	15/16"	1 3/4"	5/8"	8
6"	1206S	200	11"	9 3/4"	9 1/2"	1"	2 1/2"	3/4"	8
8"	1208S	200	13 1/2"	12 1/2"	11 3/4"	1 1/8"	3 1/4"	3/4"	8
10"	1210S	200	16"	15 1/2"	14 1/4"	1 3/16"	4 1/4"	7/8"	12
12"	1212S	200	19"	14 1/4"	17"	1 1/4"	* 5/8"	7/8"	12
14"	1214S	150	21"	15 3/4"	18 3/4"	1 3/8"	* 1 5/16"	1"	12
16"	1216S	150	23 1/2"	17 5/8"	21 1/4"	1 7/16"	* 2 1/8"	1"	16

ANSI CLASS 250									
VALVE SIZE	MODEL NO.	CWP (PSI)	A	B	C	D	E	BOLT SIZE	NO. OF BOLTS
3"	1253S	400	8 1/4"	6"	6 5/8"	1 1/8"	1 3/8"	3/4"	8
4"	1254S	400	10"	7 1/4"	7 7/8"	1 1/4"	1 3/4"	3/4"	8
6"	1256S	400	12 1/2"	9 3/4"	10 5/8"	1 7/16"	2 1/2"	3/4"	12
8"	1258S	400	15"	12 1/2"	13"	1 5/8"	3 1/4"	7/8"	12
10"	1260S	400	17 1/2"	15 1/2"	15 1/4"	1 7/8"	4 1/4"	1"	16
12"	1262S	400	20 1/2"	14 1/4"	17 3/4"	2"	* 5/8"	1 1/8"	16
14"	1264S	300	23"	15 3/4"	20 1/4"	2 1/8"	* 1 5/16"	1 1/8"	20
16"	1266S	300	25 1/2"	17 5/8"	22 1/2"	2 1/4"	* 2 1/8"	1 1/4"	20

ANSI CLASS 125 & 250 LB. REGULATED EXHAUST DEVICE

DATE Revised 5-29-98
6-29-70

VAL-MATIC[®]

VALVE AND MANUFACTURING CORP.

DRWG. NO.

VM-1200S

REGULATED EXHAUST DEVICE

1200S SERIES

STANDARD MATERIALS OF CONSTRUCTION

<u>PART NO.</u>	<u>PART NAME</u>	<u>MATERIAL</u>
1	BODY	CAST IRON ASTM A126, CLASS B
2	SEAT	BRONZE ASTM B584, ALLOY C83600
3	DISC	BRONZE ASTM B584, ALLOY C83600
5	BUSHING	BRONZE ASTM B16, ALLOY C36000
6	RETAINING SCREW	STAINLESS STEEL T304, ASTM F879
7	RETAINING NUT	BRASS

NOTE: ALL SPECIFICATIONS AS
LAST REVISED.

Revised 5-29-98

MATERIALS OF CONSTRUCTION

DATE 5/9/70

VAL-MATIC[®]

VALVE AND MANUFACTURING CORP.

DRWG. NO.

VM-1200S-M